

CRETEBEAM

COMPACT PLANT TO PRODUCE CONCRETE LATTICE GIRDER BEAMS AND LINTELS

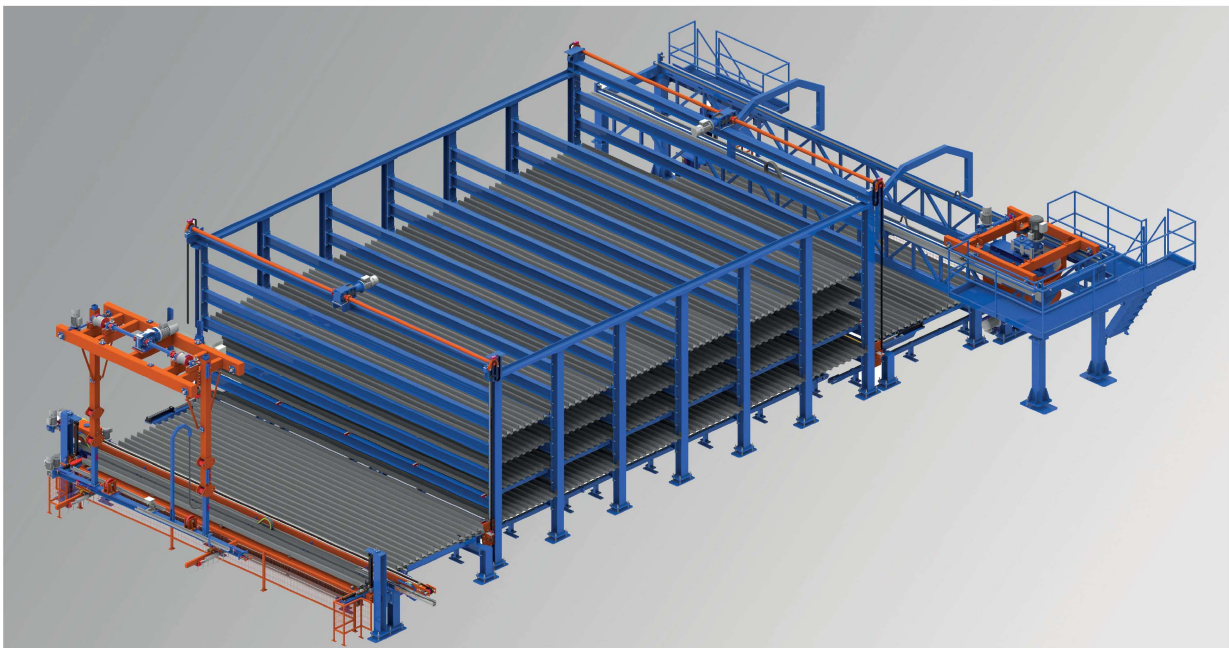

Cretebeam is designed to produce concrete lattice girder beams and lintels in semi-automatic or fully-automatic process. The modular system of the Cretebeam allows various combinations and production capacity. From fresh concrete to cured concrete element Cretebeam represents the "State of Art" of industrial facility for the precast producers.

